

matinno

LIVING

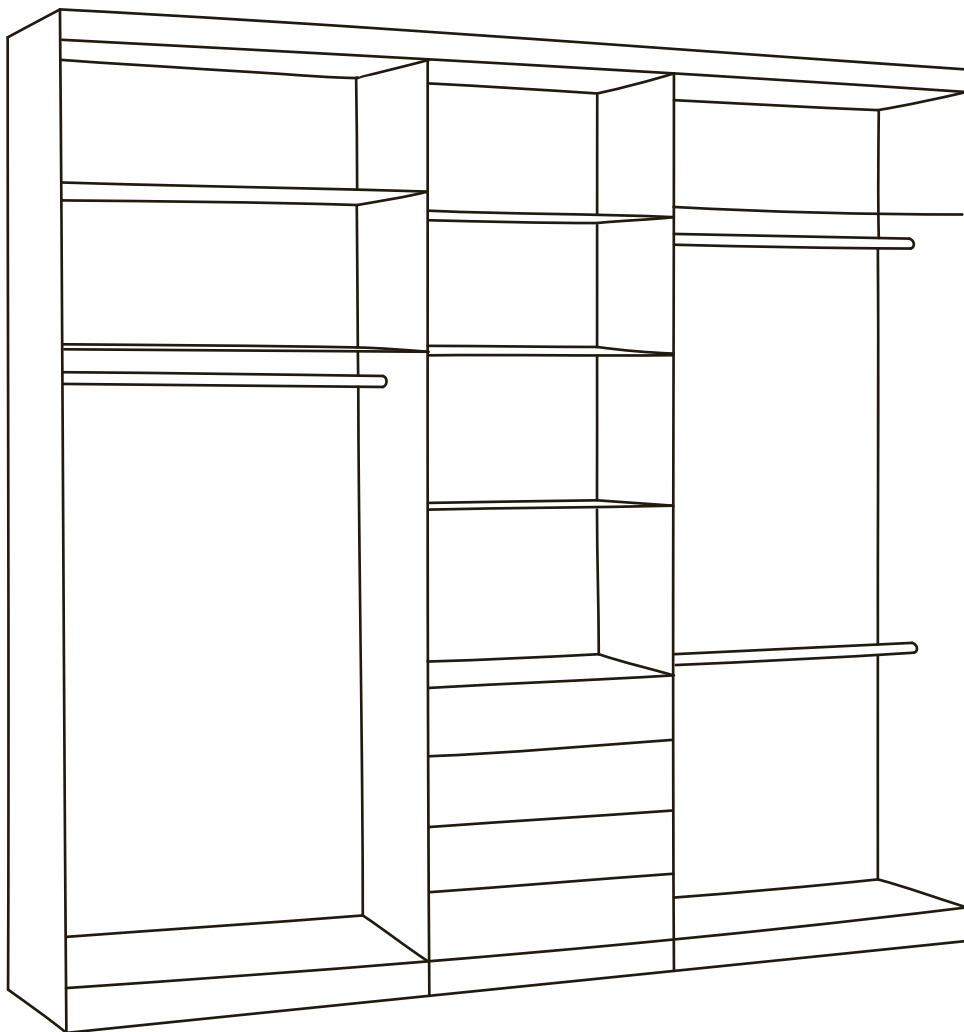

European Closets Program

2025 / Stock



Elegant Closets For Beautiful Homes

Our Closet Program

The Matinno Closets program features an easy and convenient system of sizes, a single finish, and high-quality Häfele hardware, allowing you to offer your clients a European closet program with the assurance of purchasing directly from a manufacturer.

Our closet program is an in-stock program with a 10 days lead time. You have now the best solution to install modern closets in a record time.

At Matinno we keep pushing boundaries to make sure we become your best business partner.

Closet Design

This decorative board embodies a sophisticated European design, making it perfect for modern closet applications. Its refined finish elevates any space with a timeless and elegant aesthetic. Crafted from high-quality melamine offers exceptional durability and a smooth, luxurious surface.



Lino

Closet Structure & Parts

Matinno's Closet Program is designed to meet the needs of professionals seeking the perfect balance between style and functionality. This highly customizable system seamlessly integrates into any design concept while optimizing storage solutions. Featuring limitless combinations of open shelving, sleek drawers, and premium Häfele hardware, our modular system offers unmatched flexibility for crafting tailored closet solutions. Engineered for efficiency and adaptability, it empowers businesses to deliver premium, customized spaces with precision and ease.

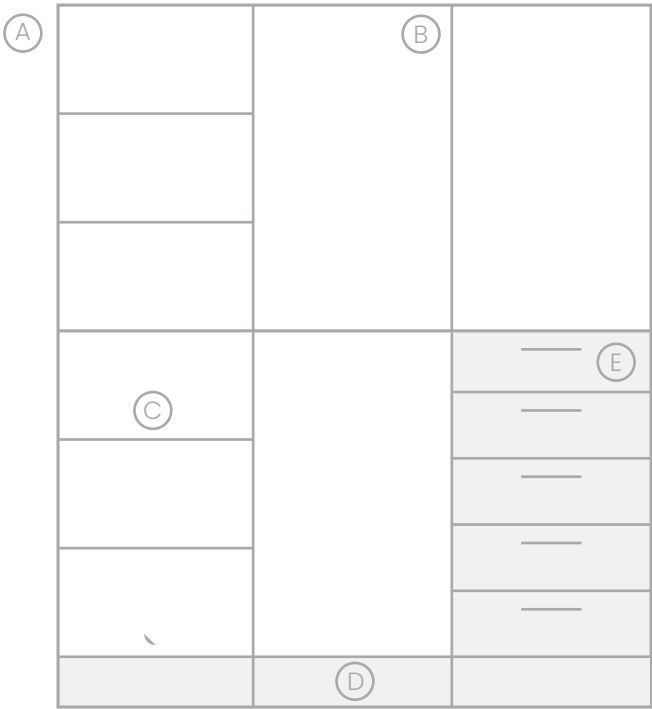

(A) Side Panels

(C) Shelves

(E) Drawers

(B) Share panels

(D) Toe Kick

Side Panels

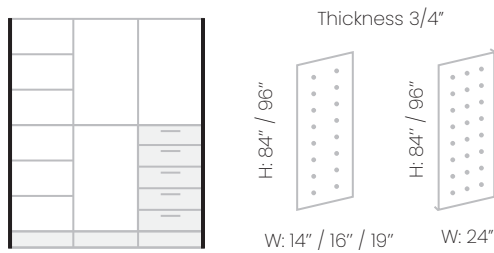

NOTES

- Drilled on one side only
- Real heights are 83 7/8" y 95 1/4". We use 84" and 96" respectively for simplification.
- 4 sides edgebanding

Share Panels

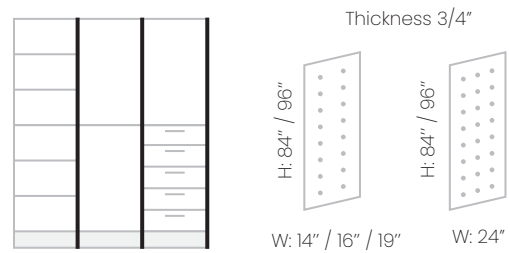

NOTES

- Double-sided drill
- Real heights are 83 7/8" y 95 1/4". We use 84" and 96" respectively for simplification.
- 4 sides edgebanding

Toe Kick

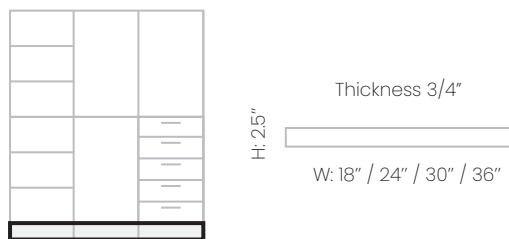

NOTE

- 2 sides edgebanding (Top and Bottom)

Drawer

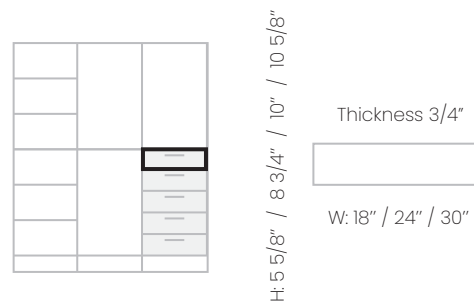

NOTE

- 4 sides edgebanding

Full Backing Panel

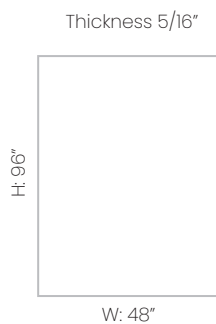

Fillers

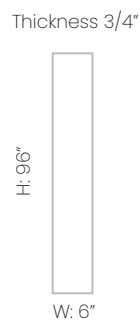

NOTE

- 4 sides edgebanding

Shelves

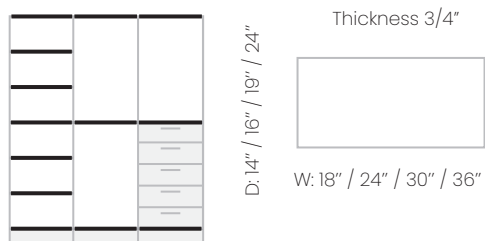

Available:

- Fixed shelves
- Adjustable shelves

NOTE

- 2 sides edgebanding (Front and Back)

Shoe Shelves

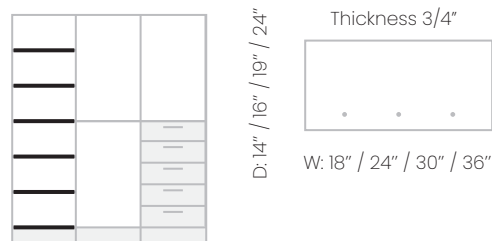

NOTE

- 2 sides edgebanding (Front and Back)

Corner Shelf

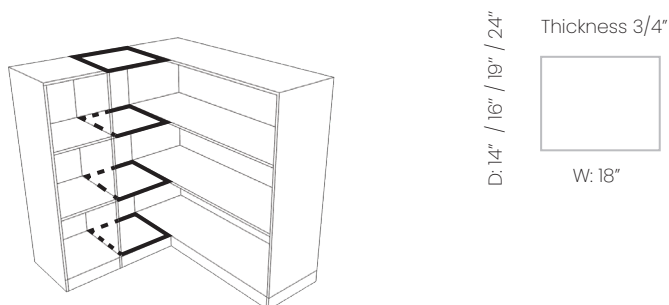

NOTES

- 2 sides edgebanding (Front and Back)
- Connection hardware sold separately. *See Hardware list*

* Edgebanding with 1mm thickness.





Drawer

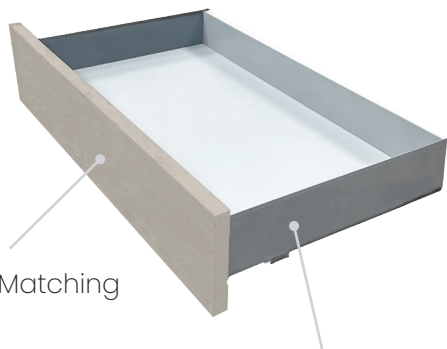

Color Matching

Single Wall Drawer Undermount
Space Saving

Our drawer optimises the storage space while enhancing aesthetics, thanks to its ultra-slim and minimalist profile, together with its concealed runners , giving the cabinet a clean and modern look.

- Concealed runners
- Full extension undermount
- Anthracite color
- 3 Wall high: 3 1/8" / 4 5/8" / 6 1/2"
- Quiet and comfortable opening and closing.

Drawer Drill Plans

Configuration 1

Configuration 2

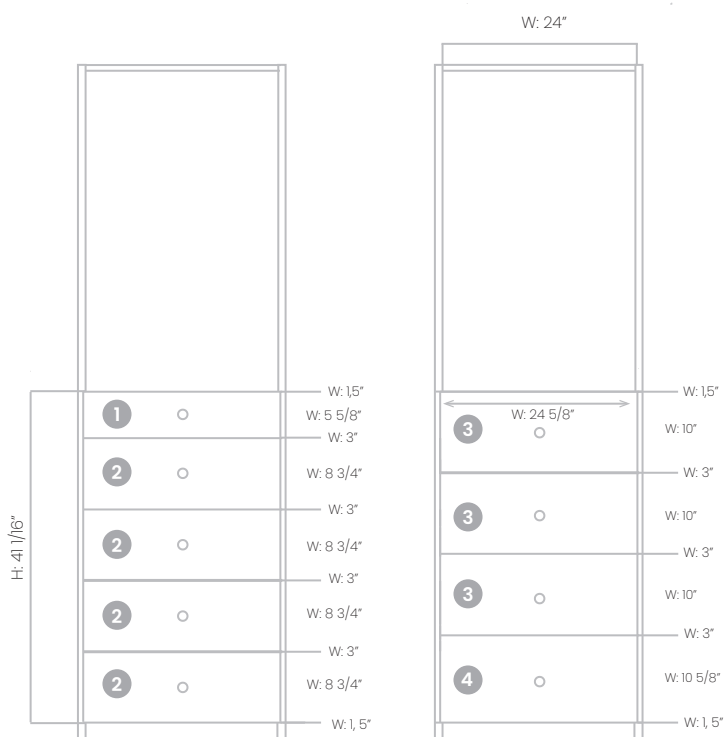

▷ = 1mm Matching Edge Banded

Drawer 1

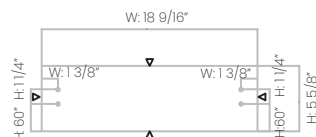

Drawer 2

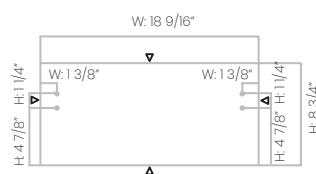

Drawer 3

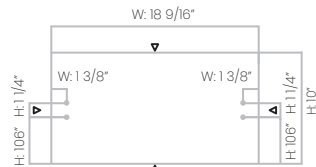

Drawer 4

*This drawer front has a different drilling.

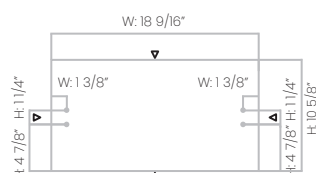

Hardware Accessories

By **HÄFELE**

HÄFELE

Häfele is a German company renowned for manufacturing high-quality hardware, locking systems, fitting systems, and architectural hardware. As a leader in closet accessories, Häfele blends innovation and functionality for stylish, precise storage solutions.

Benefits of Hardware Accessories:

- Precision-machined hardware accessories for seamless installation.
- Drill holes specifically sized for Häfele hardware, ensuring a perfect fit and quick setup.
- High-quality Häfele components for enhanced durability and a premium finish.



Wardrobe Tube with End Supports

Sizes: 18" / 24" / 30" / 36".

Finish: Black



Divided Deep Drawer

Sizes: 18" / 24" / 30" / 36".

Finish: Black Frame / Beach Fabric

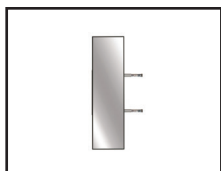

Full Rotation Mirror

Sizes: 35" / 47 3/8".

Finish: Black



Pull-Out Shoe Organizer

Sizes: 18" / 24" / 30" / 36".

Finish: Black.

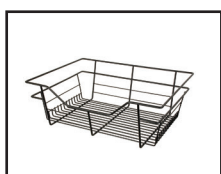

Wire Closet Basket

Full Extension Slides

Sizes: 14"x17"x6" / 14"x23"x6" / 14"x29"x6" / 14"x17"x11" / 14"x23"x11" / 14"x29"x11" / 14"x17"x17" / 14"x23"x17" / 14"x29"x17".

Finish: Black



Wardrobe Lift

Sizes: 24" / 30" / 36".

Finish: Black

Max weight capacity: 26 lbs

Hardware Accessories

By **HAFELE**



Pull-Out Shelf

Sizes: 18" / 24" / 30" / 36".

Finish: Black Frame / Beach Fabric



Divided Lingerie Drawer

Sizes: 18" / 24" / 30" / 36".

Finish: Black Frame / Beach Fabric

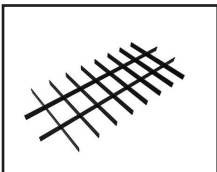

Jewelry Organizer

Sizes: 18" / 24" / 30" / 36".

Finish: Black



Pant Organizer

Sizes: 18", 12 Hangers / 24", 18 Hangers / 30", 24 Hangers / 36", 30 Hangers

Finish: Black

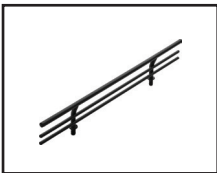

Shelf Shoe Fence

Sizes: 18" / 24" / 30" / 36".

Finish: Black



Belt Rack

Description: 6 Hook, 13 7/8", with full extension slide.

Finish: Black.



Valet

Description: For clothes hangers and hanging garment bags.

Finish: Black



Jewelry Organizer

Finish: Black



Tie Rack

Description: With full extension slide.

Finish: Black

Assembly Hardware

By **HÄFELE**



Rafix Flush System

Description: Allows the shelves to be securely locked in place. (Fixed Shelves).

Finish: Black



Rafix Tab System

Description: Allows for easy placement and removal of the shelf.

Finish: Black



Rafix Bold

Description: Used to lock the Rafix Flush System.

Finish: Silver



Rafix Shelf Pin

Description: Use to install the Rafix Tab System.

Finish: Silver



Rafix Connecting Bolt

Description: Used to connect and lock the corner shelves.

Finish: Silver



Shelf Support

Description: The support used to place the shoe shelves.

Finish: Silver

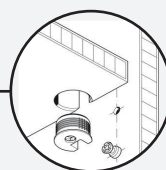
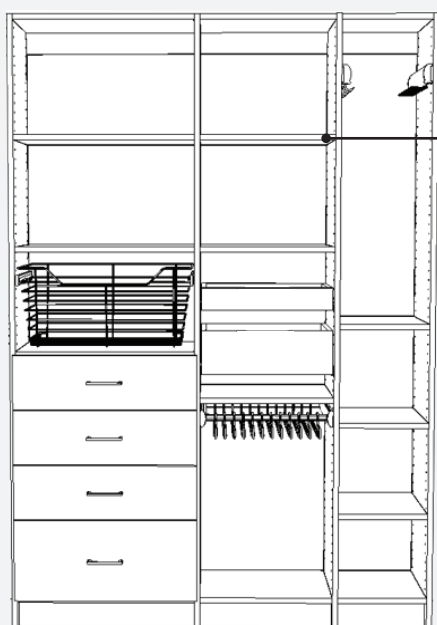

Rafix

Assembly of all systems start with the connectors and hardware's for each component. All parts connect too and follow the 32mm line boring system holes making adjustability quick and easy as storage requirements change.

Configurations • Examples

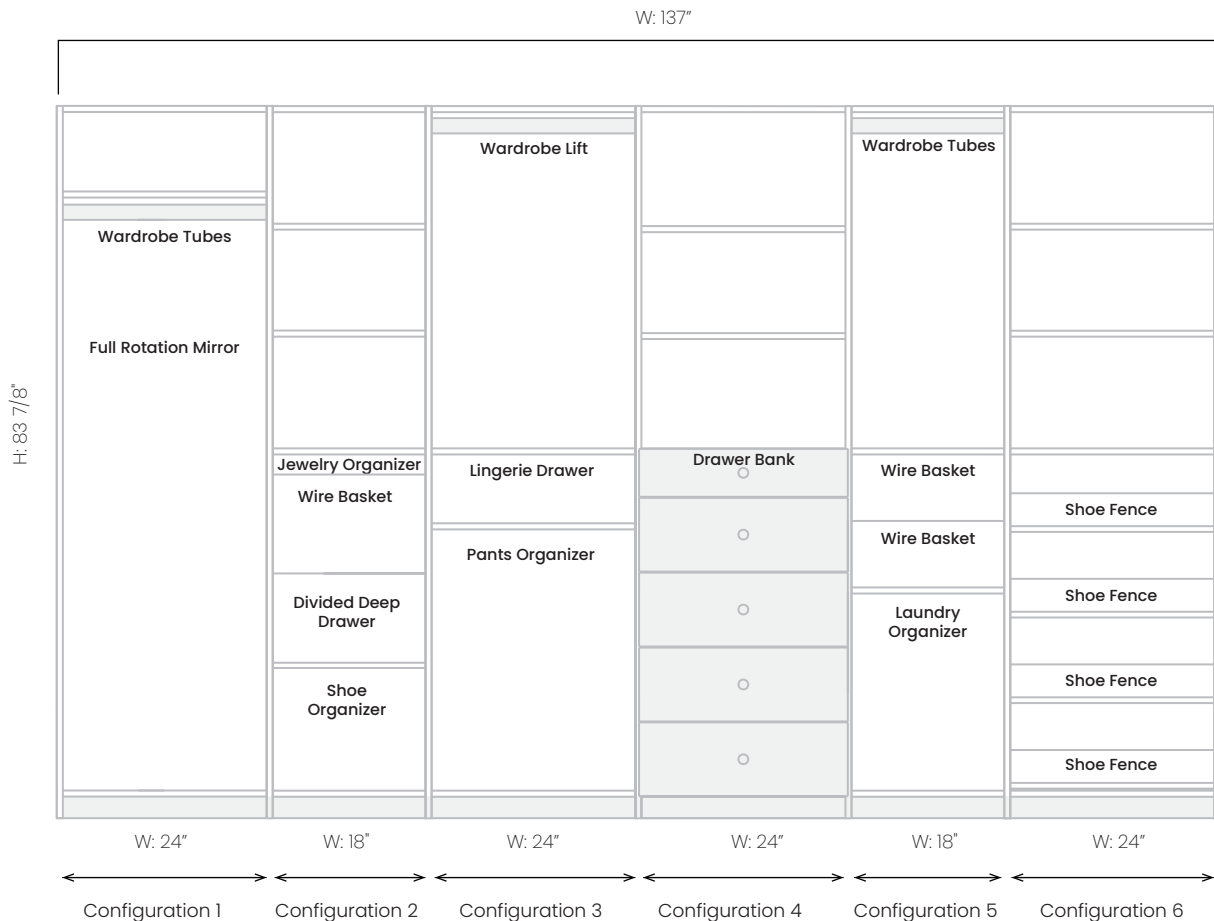

Breakdown

2 Side Panels

D: 14"

H: 83 7/8"

5 Share Panels

D: 3 x 14", 2 x 16"

H: 83 7/8"

8 Fixed Shelves and

4 Adjustable Shelf

D: 14"

W: 24"

6 Fixed Shelves and

4 Adjustable Shelf

D: 14"

W: 18"

3 Fixed Shelves and

2 Adjustable Shelf

D: 16"

W: 24"

4 Shoe Shelves

D: 14"

W: 24"

5 Drawers

D: 16"

W: 24"

H: 1 x 5 5/8" and 4 x 8 3/4".

Wardrobe Tubes

W: 1 x 18", 1 x 24"

1 Wardrobe Lift

W: 24"

1 Full Rotation Mirror

1 Jewelry Organizer

W: 18"

3 Wire Basket

W: 1 x 14"x17"x11", 2 x 14"x17"x6"

1 Divided Deep Drawer

W: 24"

1 Shoe Organizer

W: 18"

1 Lingerie Drawer

W: 24"

1 Pants Organizer

W: 24"

1 Laundry Organizer

W: 18"

4 Shoe Fence

W: 24"

Configurations • Examples

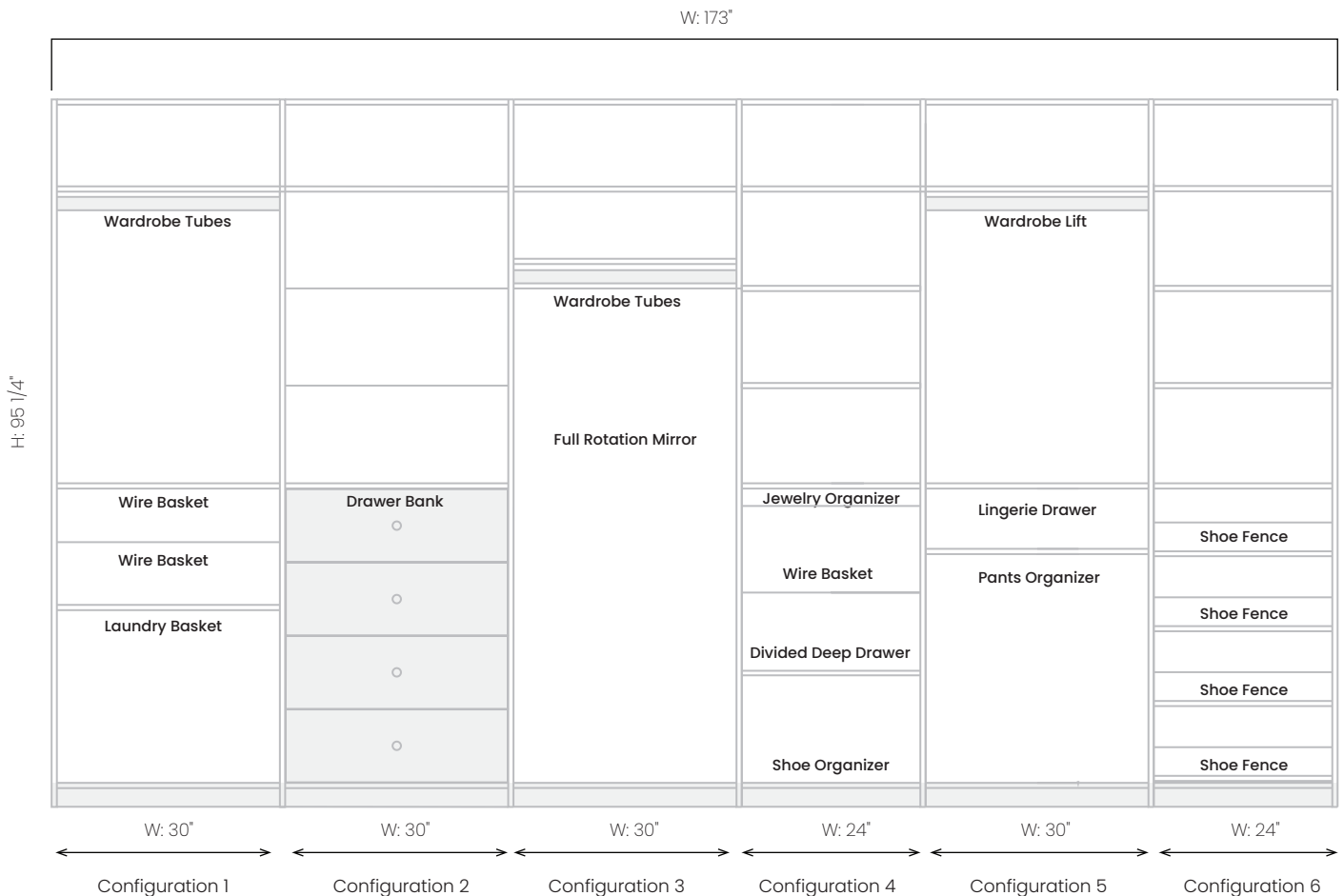

Breakdown

2 Side Panels

D: 14"
H: 95 1/4"

5 Share Panels

D: 5 x 14", 2 x 16"
H: 95 1/4"

8 Fixed Shelves and 7 Adjustable Shelf

D: 14"
W: 30"

6 Fixed Shelves and 7 Adjustable Shelf

D: 14"
W: 24"

3 Fixed Shelves and 1 Adjustable Shelf

D: 16"
W: 30"

4 Shoe Shelves

D: 14"
W: 24"

4 Drawers

D: 16"
W: 24"
H: 1 x 10 5/8", 3 x 10"

2 Wardrobe Tubes

W: 30"

1 Wardrobe Lift

W: 30"

1 Full Rotation Mirror

1 Jewelry Organizer

W: 24"

3 Wire Basket

1 x 14"x23"x11", 2 x 14"x23"x6"

1 Divided Deep Drawer

W: 24"

1 Shoe Organizer

W: 24"

1 Lingerie Drawer

W: 30"

1 Pants Organizer

W: 30"

1 Laundry Organizer

W: 30"

4 Shoe Fence

W: 24"

CLOSET WITH CUSTOM DRAWER FRONT



CLOSET WITH CUSTOM DOORS



FAQ

Limited Lifetime Warranty

At Matinno, we stand behind everything we do and offer a convenient way to report any claim or problem. Our products are rigorously tested and produced upon the strict quality protocols. Our quality standards are certified by industry-recognized testing associations ensuring our products are built to last. We offer our customers a 5-year warranty on all our products.

We believe a product is only as good as the service that supports it, and we have a great team of experienced cabinet professionals ready to hear your concerns and answer your questions. Most importantly, we listen to the input our customers give us and make sure your suggestions are addressed as we continually seek ways to better serve you.

Doors, Drawers Front & Decorative Sides

All Matinno's range of designs and technologies are available. Featuring our proprietary finishes, the LUXE, ZENIT, and SYNCRON.

No matter your style preference—whether it's a sleek supermatte, a richly textured finish, or a dazzling high-gloss look—Matinno's Closet Program offers endless design possibilities. With a wide selection of colors and advanced surface technologies, you can create a closet that perfectly reflects your vision. Explore the many options available below and bring your dream closet to life.

Islands

Designed to maximize storage while adding a touch of sophistication, our closet islands offer the perfect balance between style and practicality. Whether you need extra drawers for accessories, or a seamless surface for organization, our designs are crafted to elevate your space.

For more details on how to customize your walk-in closet island, contact our customer service team—we're here to bring your vision to life.

Handles

Enhance your closets with our wide variety of handles. From modern to classic designs, find the perfect mix of style, quality, and functionality.

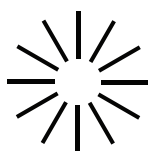

matinno
LIVING

CONTACT US

305-602-8193

contactus@matinnoliving.com