

# OUTDOOR KITCHEN

by MATINNO LIVING

—  
INSPIRE YOUR  
OUTDOORS

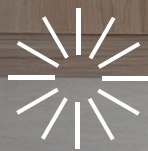

**matinno**  
LIVING







# Outdoor Kitchen Program

*Innovation Meets the Outdoors*

At Martinno Living, we believe that great design should not stop at the door. Our Outdoor Kitchen Program brings the same sleek, modern style of our renowned indoor kitchens to the open-air experience. Thoughtfully crafted to blend durability with elegance, our outdoor kitchens combine premium-quality materials with refined finishes, creating seamless harmony between indoor and outdoor living spaces.

Every element—from cabinet construction to surface details—reflects the commitment to excellence that defines Martinno Living. Whether you're entertaining guests or enjoying a quiet evening under the stars, our outdoor kitchens deliver beauty, performance, and continuity in design. Now, the heart of your home extends outdoors, maintaining the same level of sophistication you expect.

# Cabinet | Specifications

## Materials and Construction

### OPTION 1 | Phenolic Core Structure

Back Panel inserted into the groove of the side panels

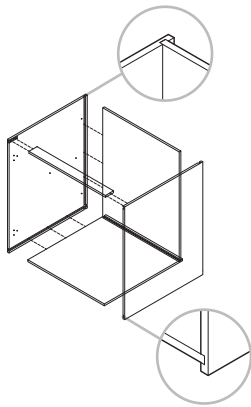

Bottom Panel inserted into the side panels. Reinforced with Stainless Steel Screws and Epoxy Adhesive

- ½" HPL Phenolic Board with a decorative laminate finish.
- Exceptional resistance to moisture, chemicals, heat (up to 160°C), fire, and surface wear.
- High-density composition (1.40 g/cm<sup>3</sup>) for superior mechanical durability.
- Compliant with EN 438 standards.
- Smooth and easy-to-clean surface.
- Ideal for demanding environments and outdoor applications.
- Recommended for base cabinets

### OPTION 2 | Tricoya Core Structure

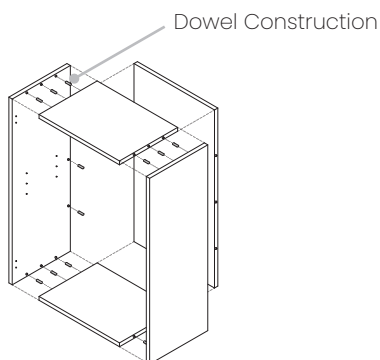

- ¾" Tricoya® high-performance, water proof MDF.
- Durable and stable in wet areas, designed to resist moisture and withstand harsh weather conditions.
- Classified for Class 4 use under EN 335, suitable for direct contact with water.
- Recommended for Wall Cabinets and Pantries



# Hardware | Specifications

## DRAWERS

Hettich Outdoor Program – InnoTech Atira



- Hettich Quadro V6
- Quadro runners (partial/full extension) with up to 110 Lbs load capacity.
- Soft Close Undermount.
- Stainless Steel Sides
- Both the bottom and back panels are made from Tricoya.

## ADJUSTABLE LEG LEVELERS



- Made of durable, weather-resistant plastic
- Adjustable height up to 6 inches
- Perfect for leveling cabinets on uneven outdoor surfaces
- Ensures stable and secure installation
- Built to withstand harsh outdoor conditions and heavy loads.

## HINGES

Hettich Outdoor Program – Veosys



- Soft Close
- Stainless steel.

# Hardware | Specifications

## ASSEMBLY HARDWARE

### Screws



- Stainless steel.
- Highly resistant to rust, corrosion, and staining
- Withstands high temperatures

### Brass Dowels



- For Phenolic Cabinet assembly.
- Corrosion resistance
- Excellent longevity

### Wood Dowels



- For Tricoya Cabinet assembly

## TRASH & PROPANE PULL-OUT

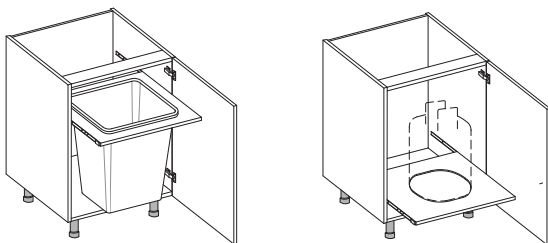

- Stainless Steel Full Extension Slides
- Structure made with Phenolic



# Slab Door | Specifications & Range

## Designs



## **TRICOYA®** *Superior Outdoor Performance*

The doors of our outdoor kitchens are crafted from Tricoya®, a high-performance wood fiberboard engineered for exceptional durability in extreme outdoor conditions. This premium material is also used in other components, including decorative panels, fillers, toe kicks, bottom panels, and drawer back panels. Tricoya® offers outstanding dimensional stability, is suitable for direct water contact, and carries a warranty of up to 50 years for above-ground applications.

Manufactured without formaldehyde and certified to international environmental standards, Tricoya® ensures safety, sustainability, and superior performance in outdoor environments.

For lasting edge protection, we use PUR (Polyurethane Reactive) glue for all edgebanding. This advanced adhesive forms a robust, waterproof bond that resists heat, humidity, and delamination, far surpassing the performance of conventional glues.

---

\* Every surface boasts advanced UV protection, engineered to shield your outdoor kitchen from the sun's relentless rays, ensuring vibrant colors and flawless finishes that stand the test of time.

# Cabinetry | Sizes & Modulations

Crafted to elevate outdoor living, our outdoor kitchen program blends versatile design, refined finishes, and durable construction to deliver functional and aesthetically stunning kitchens. Each cabinet is engineered for seamless integration into any layout, with a standard height of 30" (excluding adjustable legs) to ensure compatibility with conventional countertop installations. Perfect for transforming patios, terraces, and entertainment spaces, our program offers sophistication, resilience, and effortless customization.

## Base Cabinet • 1 Door

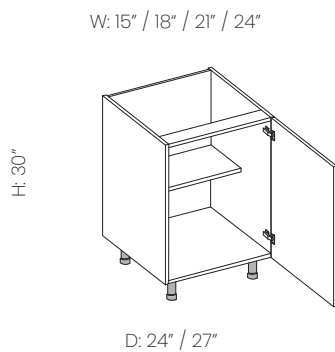

## Base Cabinet • 2 Door

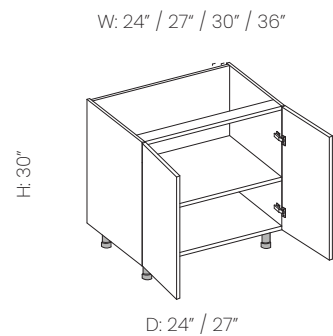

## Base Cabinet • 1 Door 1 Drawer

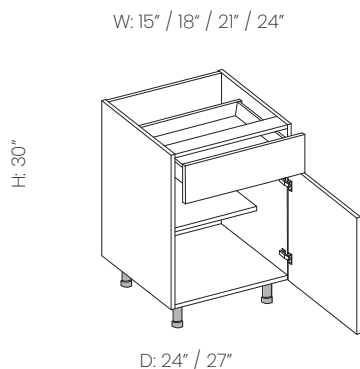

## Base Cabinet • 2 Door 1 Drawer

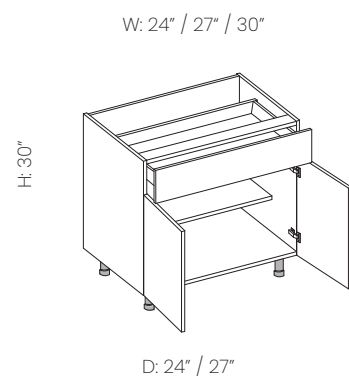

- 
- \* All cabinets include an interior shelf but for drawer cabinets
  - \* False Front, Panels and Fillers are made with Tricoya



# Cabinetry | Sizes & Modulations

## Base Cabinet • 2 Bottom 1 Top Drawer

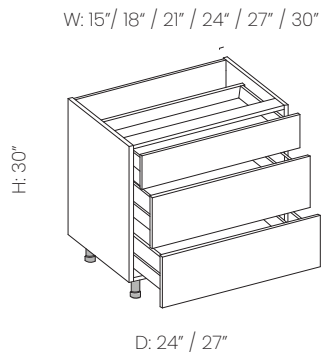

## Sink Base Cabinet • 2 Door

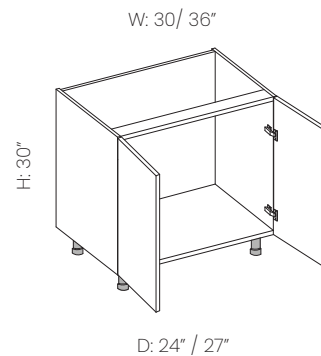

NOTE:

- Shelf not included

## Trash Pull-Out Cabinet

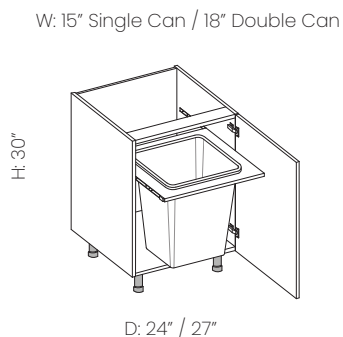

### NOTES

- Stainless-Steel Full Extension Slides
- Bin tray made with Phenolic Core

## Propane Tank Pull-Out Cabinet

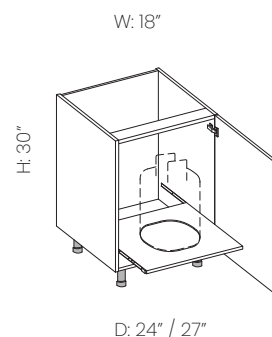

### NOTES

- Stainless-Steel Full Extension Slides
- Bin tray made with Phenolic Core
- Air Vent Grille Included

\* All cabinets include an interior shelf but for drawer cabinets  
 \* False Front, Panels, and Fillers are made with Tricoya

# Cabinetry | Sizes & Modulations

## Base Cabinet • Grill 2 Door

W: 36" / 39" / 42" / 45" / 48"

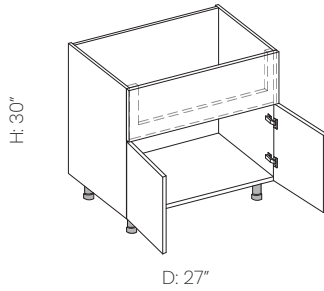

D: 27"

NOTE:

- Air Vent Grille Included

## Base Cabinet • Side Burner 1 Door

W: 15" / 18" / 21"

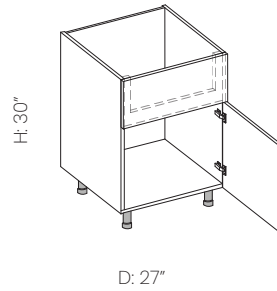

D: 27"

NOTE:

- Air Vent Grille Included

## Base Cabinet • Side Burner 2 Door

W: 24" / 27" / 30" / 33" / 36"

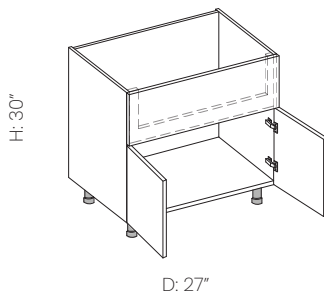

D: 27"

NOTE:

- Air Vent Grille Included

## Base End Panel

W: 18"

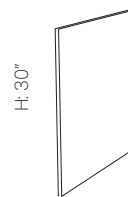

D: 24 7/8" / 27 7/8"

## Toe Kick

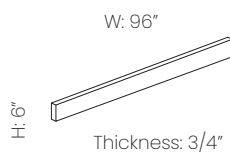

Thickness: 3/4"

## Filler

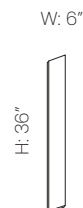

\* False Front, Panels and, Fillers are made with Tricoya.

\* Grill base cabinets feature a false front.

\* Fillers and Toe Kicks are offered with standard sizes. Customization, if needed, to be done on site.



# Special Bases | Specifications

## Air Vent Grille

Effective ventilation is a cornerstone of outdoor kitchen design. Continuous airflow within the cabinetry prevents the accumulation of moisture, gases, and excessive heat, safeguarding appliances and materials from damage. This proactive approach mitigates corrosion and significantly extends the lifespan of the entire installation. Beyond structural benefits, The Air Vent Grille is also critical feature for the safe and optimal performance of gas-powered appliances, ensuring proper combustion and minimizing the risk of hazardous vapor buildup.

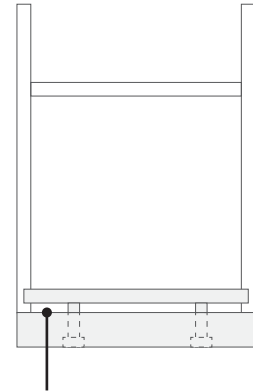

The 1/2" opening between the toe kick and bottom panel facilitates optimal airflow and ventilation efficiency.



The grill allows the cabinet to dissipate heat, enabling proper ventilation of warm air

## Grill Base

**Construction:** Assembled using dowels and strategically placed stainless steel screws for robust durability.

**Insulation Requirement:** All grills require an insulation jacket, hence a base cabinet of at least 6" wider than the grill dimensions.

**Front Panel Customization:** Features a 12" high front panel that must be cut to accommodate the insulation jacket's dimensions. The final height is calculated as: grill height - countertop thickness = front cut-out height.

**Height and Adjustability:** Standard height of 30" (excluding countertop), with 6" adjustable plastic leveling legs for precise installation.

**Depth and Ventilation:** Standard depth of 27", equipped with ventilation grills integrated into the cabinet deck for optimal airflow.

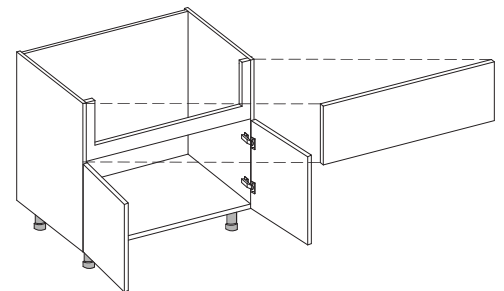

# FAQ | Matinno Living Outdoor Kitchens

## Custom Cabinets

At Matinno Living, our Custom Cabinets for Outdoor Kitchens bring innovation and elegance to outdoor living. Engineered to endure harsh elements while maintaining a sophisticated aesthetic, our cabinets are crafted from high-performance materials for exceptional durability and low maintenance. Ideal for outdoor kitchens, entertainment spaces, or any exterior setting, our customizable solutions seamlessly blend modern design with practical functionality.

Contact our Customer Service team to explore options and elevate your outdoor space today!

## Handles

Transform your outdoor kitchen with Matinno Living's diverse handle collection. Offering a range of styles from sleek modern to timeless classic, our handles combine superior quality, durability, and ergonomic design.

## Limited Lifetime | Warranty

This warranty applies exclusively to Matinno Living Outdoor Kitchens. The warranty period begins on the date of delivery. If you need to make a warranty claim, please contact the Matinno Living Center where you purchased the cabinetry. By installing or using the product, the user accepts all terms described in this document. Matinno Living takes great pride in the craftsmanship of our outdoor kitchen cabinetry and furniture.

Matinno Living warrants to the original purchaser that its outdoor kitchen cabinetry and components will be free from defects in materials and workmanship for the duration specified in this warranty. This warranty is non-transferable. Matinno Living will repair or replace any defective materials under the terms of this warranty. All products must have been purchased through an authorized Matinno Living Center. This warranty does not cover the removal, transportation, or installation of defective or replacement materials. It is limited to the replacement or repair of defective parts or materials only.

Any components not manufactured by Matinno Living will be subject to the original manufacturer's warranty, dependent on availability from the supplier.

Matinno Living's liability shall not exceed the original purchase price of the product and shall exclude any taxes, shipping, or handling charges.

## WARRANTY COVERAGE

### Materials

Matinno Living outdoor kitchen cabinetry is crafted using premium materials, including Phenolic Panels and Tricoya Panels, selected for their resilience in outdoor environments.

- **Phenolic Panels:** These panels offer exceptional mechanical strength, a high density (1.40 g/cm<sup>3</sup>), and compliance with EN 438 standards. They resist moisture, heat (up to 160°C), and surface wear, maintaining a smooth, easy-to-clean finish.
- **Tricoya Panels:** Engineered for superior durability and dimensional stability, Tricoya is a high-performance fiberboard ideal for extreme moisture and environmental conditions. Classified for Class 4 use under EN 335, it is suitable for direct water contact. Manufactured using a formaldehyde-free process, Tricoya complies with CARB Phase 2 and TSCA Title VI regulations. It carries a 50-year warranty for above-ground applications and a 25-year warranty for in-ground contact.

### Metal Accessories

All Matinno Living outdoor kitchen accessories, including hinges, handles, and rails, are made from stainless steel, ensuring corrosion resistance, durability in humid conditions, and long-term reliability.

### Color Fading Warranty

Matinno Living guarantees that its outdoor kitchen doors and decorative panels will maintain their original color and finish for five (5) years, covering fading or discoloration due to normal exposure to light and heat.



## EXCLUSIONS FROM WARRANTY

This warranty does not cover:

- Improper installation, removal, or repairs by unauthorized contractors or individuals.
- Use of inappropriate cleaning products, such as abrasive or chemical-based cleaners, that deviate from Matinno Living's cleaning guidelines.
- Normal wear and tear, including minor surface scratches, gloss reduction, or slight appearance changes due to environmental exposure.
- Damage from improper maintenance, neglect, or exposure to extreme conditions, such as high humidity, water pooling, direct flame, or high concentrations of salt or chemicals.
- Cosmetic damage not reported within 48 hours of delivery. Products must be inspected prior to installation, as installing visibly defective products voids this warranty.
- Discoloration, rust, or oxidation of metal components due to exposure to corrosive elements.
- Damage from natural disasters or unforeseen events, including earthquakes, hurricanes, floods, fires, or other acts of nature.
- Commercial use: For commercial applications (e.g., multi-family units, offices, or hospitality settings), the warranty is limited to five (5) years and excludes industrial environments, professional kitchens, or chemically harsh conditions.

## WARRANTY CLAIMS FOR DISCONTINUED PRODUCTS

If a claim involves a discontinued product, Matinno Living will, at its discretion:

- Replace the defective component with an identical style, if available.
- Provide a comparable style to ensure a cohesive appearance.

Due to natural aging and production variations, replacement components may not perfectly match the original product in color, grain, or finish. Warranty repairs or replacements do not extend the original warranty period.

Matinno Living reserves the right to modify product designs, specifications, and materials without obligation to update previously manufactured products.



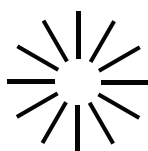

**matinno**  
LIVING

## **CONTACT US**

305-602-8193

[contactus@matinnoliving.com](mailto:contactus@matinnoliving.com)